



Fine Arts Theater Technical Information Packet

5/11/2006

General Information:

Location: Fine Arts Theater is located at the corner of Baldwin and Lumpkin Streets in the Fine Arts Building. The loading dock entrance is off Baldwin St. The lobby / box office entrance is facing Baldwin St.

Parking: The parking lot off Baldwin St. is for loading and unloading only.
From Loading Dock Parking Area: (Fine Arts Building)

Option #1: Tate Center Pay Lot

Turn **Left** onto Baldwin Street. Turn **Left** at the traffic light (Baldwin and Lumpkin). Continue through first traffic light (Lumpkin and Baxter). Turn **Left** at the next light into parking area and proceed to gated area to receive time stamped parking ticket.

Option #2: Hull Street Parking Deck

Turn **Left** onto Baldwin Street. At the traffic light (Baldwin and Lumpkin), turn **Left** onto Lumpkin Street. At the next traffic light, turn **Right** onto Baxter Street. Take the first **Right** onto Hull Street. Turn **Left** into Parking Deck Area. Get time stamped ticket and proceed to park. (To walk back to the Fine Arts Theatre: Come out of parking deck, cross Hull Street, turn **Left** and continue up the hill until Florida Street is on your left (DO NOT turn on Florida Street). At Florida Street, turn **Right** and begin to cross the parking lot toward Lumpkin Street. You should intersect Lumpkin Street near the intersection of Baldwin and Lumpkin with the Fine Arts Theatre across the street.) Deck rates: \$2 for 1st hour, \$1 each additional hour. Maximum \$8 per day.

Option #3: Jackson Street Parking Deck

Turn **Right** onto Baldwin Street. At the 2nd light, turn **Left** onto Jackson Street. Continue up Jackson Street for approximately a quarter mile and the North Campus Parking Deck will be on the Right. Enter, take time stamped parking ticket, and enter gate to park.

(To walk back to Fine Arts Theatre: Walk from parking deck out to Jackson Street, turn **Left**. Continue until Jackson intersects Baldwin Street (stop light) **cross the street** and take a **Right**. Continue down Baldwin Street, through a stop light, and the Fine Arts Theatre will come up on the **Left**. Deck rates: \$2 for 1st hour, \$1 each additional hour. Maximum \$8 per day.

After 5pm all permit lots are open to the public. The Performing Arts Center cannot be held responsible for any parking tickets.

Seating: Main Section - 493 seats, continental style.
Rear Section - 248 seats, standard configuration w/ center aisle.
Total Capacity - 741

Dressing Rooms: The dressing rooms are located one level below the stage. Access to the stage is a stairwell leading to the upstage left wing. There are 4 small dressing rooms and 2 chorus dressing rooms equipped with make-up tables and sinks. Restrooms with showers are also located off this corridor. No smoking is permitted in this facility. Entrance to the facility for performers and staff should be made at the loading dock entrance.



Fine Arts Theater Technical Information Packet

5/11/2006

Contact Information:

Mailing Address: 230 River Road
Performing Arts Center, UGA
Athens, Ga. 30602-7280

General Fax: 706-542-8867
Main phone: 706-542-1668
Box Office: 888-289-8497

Staff:

Technical Director	Graf Imhoof	office: 706-542-4560	email: gvimhoof@uga.edu
Box Office Manager	Kimberlee Baumgarner	office: 706-542-6383	email: kbaumgar@uga.edu
Stage Manager	Jill Kelly	office: 706-542-1789	email: Bluegrassjill@aol.com
House Manager	Lori Tiller	office: 706-542-2290	email: lrl@uga.edu

Technical Information:

Stage:

Proscenium opening - 43' wide, 28' high.
Height of stage above front row - 3' 9"
Distance from stage edge to plaster line - 5' 6"
Distance from plaster line to back wall - 31'
Stage left wing - appx. 16' x 31' x 12' high
Stage right wing - appx. 24' x 31' x 12' high
Grid height - 58'
Number of lines - 30
Average batten length - 48' **BATTEN I.D. = 2.0"**

Floor: Stage floor is 1/4 inch masonite over 2" x 6" tongue and groove pine.
Stage floor has a flat black finish.

Curtains: Legs (10) - 30' high x 9' wide - black
Borders (4) - 12' high x 48' wide - A
Main curtain (1) - 28' high x 46' wide - blue velour (will travel & guillotine)
Valence (1) - 12' high x 46' wide - blue velour
White Cyc (1) - 28' high x 48' wide
Black Scrim (1) - 28' high x 48' wide

Rigging: Counter weight lines are double purchase, with the operating position off the deck stage right, 25'9" above the stage floor.
House trim height is 24'-25'.
Maximum weight for all line-sets is 900lbs.



Fine Arts Theater Technical Information Packet

5/11/2006

Line-set schedule

Line #	Depth from plaster-line	Contents	Notes	Weight
Fire	6"	Fire Curtain		
1	1'-1.5"	Valance	Blue	130lbs
2	1'-11.5"	Main Curtain	Blue	310lbs
3	2'-9.5"			
4	3'-10.5"	House Electric 1	Circuits 121-144	
5	5'-3.5"			
6	6'-1.5"	9' Black Legs	15' from center	54lbs
7	7'-2.5"			
8	8'-7.5"			
9	9'-5.5"			
10	10'-3.5"			
11	11'-1.5"	Black Border		54lbs
12	11'-11.5"	9' Black Legs	15' from center	54lbs
13	12'-9.5"			
14	13'-9"	House Electric 2	Circuits 145-166	
15	14'-8.5"			
16	16'-5"			
17	17'-3"			
18	18'-1"			
19	18'-11"	9' Black Legs	15' from center	54lbs
20	20'			
21	20'-10"	Full Black		162lbs
22	22'-3"	Black Border		54lbs
23	23'-1"			
24	23'-11"	House Electric 3	Circuits 167-186	
25	25'-7"			
26	26'-8"	Black Scrim		40lbs
27	28'-1"	9' Black Legs	15' from center	54lbs
28	28'-11"	Cyc Elec.	Drop Boxes	
29	29'-9"			
30	30'-7"	White Cyc		85lbs



Fine Arts Theater Technical Information Packet

5/11/2006

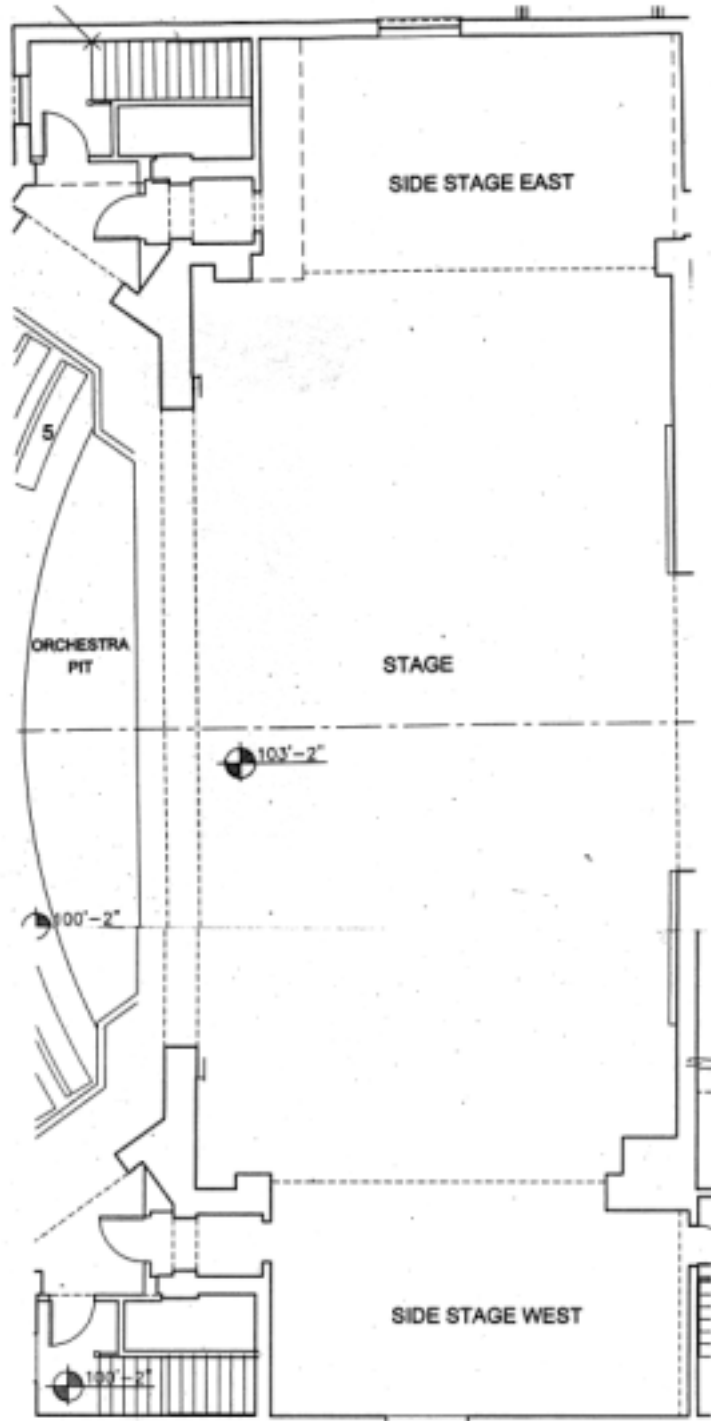



Fine Arts Theater Technical Information Packet

5/11/2006

Sound:

Mackie CR1604-VLZ 16-channel mic/line mixer
CD player
Front of house speaker system
2 side-fill stage monitors
1 SM58 microphone with Stand
Single channel Clear-Com headset system

Lighting:

Lighting Control:

ETC Expression 3 control console version 3.03
246 Dimmers - ETC Sensor 2.4kW Dimmers

Lighting Circuits:

Front of house:

Catwalks #1 - 20 circuits (73-92), 10' horizontal from plaster line - 30' throw to plaster line.
#2 - 23 circuits (45-72), 22' horizontal from plaster line - 35' throw to plaster line.
#3 - 28 circuits (17-44), 34' horizontal from plaster line - 41' throw to plaster line.
#4 - 12 circuits (5-16), 46' horizontal from plaster line - 52' throw to plaster line.
#5 - 4 circuits (1-4), 65' throw to plaster line.
SL Box position - 6 circuits (109-114)
SR Box position - 5 circuits (115-119)
SL Slot position - 8 circuits (93-100)
SR Slot position - 8 circuits (101-108)

On Stage electrics:

#1 electric - 24 circuits (121-144)- line set 4 - 3' - 10 2@ from plaster line.
#2 electric - 22 circuits (145-166)- line set 14 - 13' - 9" from plaster line.
#3 electric - 20 circuits (167-186)- line set 24 - 23' - 11" from plaster line.
SL tormentor - 8 circuits (195-202)
SR tormentor - 8 circuits (187-194)
SL floor pockets - 5 circuits (208-212)
SR floor pockets - 5 circuits (203-207)
US floor pockets - 9 circuits (213-218,222-224)
Drop boxes - 4 total 1) 12 circuits DSR (225-236)
2) 10 circuits USR (237-246) - duplicated SL
3) 6 circuits DSL (237-242)
4) 5 circuits USL (243-247)

(Note: All connections are 3 wire, grounded, stage pin connectors)



Fine Arts Theater Technical Information Packet

5/11/2006

Lighting Instrument Inventory

Quantity	Description	Wattage	Lamp	Field Angle	Gel Frame	Weight
22	ETC 19 degree S4	575	HPL	19	6.25" X 6.25"	17lbs
52	ETC 26 degree S4	575	HPL	26	6.25" X 6.25"	17lbs
42	ETC 36 degree S4	575	HPL	36	6.25" X 6.25"	17lbs
2	ETC 25-50 degree S4 zoom Altman 175Q 8" fresnel	750	HPL	25-50	7.5" X 7.5"	17lbs
10	spotlights	1000	BVT	Dec-50	10" X 10"	18lbs
20	Colortran 8" fresnel spotlights	1000	BVT	18598	10" X 10"	23lbs
20	Par64	1000	FFS/FFR/FF P	44/24/16	10" X 10"	12lbs
6	L&E Broad Cyc 3 cell	1000/cel 1000/cel	FHM	N/A	10.125" X 11.33"	40lbs
6	Selecon Aurora Cyc 3 cell	1000/cel 1000/cel	FGV	N/A	12" X 12.375"	48lbs